



APREAMARE 48 NEW
APREAMARE 48 (2020)

Ref1305

Aprea Mare

Located: France

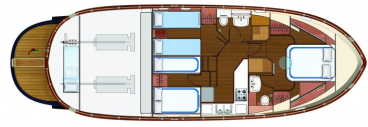

APREAMARE 48 NEW

APREAMARE 48 (2020)

Aprea Mare

Length 14.6 M (48')

Located: France

Ref1305

€ 850 000

MANAGEMENT
PROGRAM



Type	Modern
Propulsion	Power
Hull	Mono
Length	14.6m (48')
Beam	4.7m (16')
Draft	1.3m (5')
Hull Material	Fiberglass
Engine	2 / Volvo Penta / D8-600
Engine HP	600
Guests	8
Guest Cabin(s)	3
Crew Cabin(s)	1
Built/Refit	2020/-
Builder	



APREAMARE 48 NEW
APREAMARE 48 (2020)

Ref1305

Apréa Mare

Located: France

Comments: 3 cabins (1 Master cabin, 1 double cabin with twin beds, 1 cabin triple) with 2 bathrooms + 1 crew cabin with shower & toilet.

To answer to the needs of consumers who are loyal to sober and traditional lines of the shipyard and for the excitement showed for the previous models, the motivation has risen to guarantee new evolutions to Apreamare 48', respecting innovative solutions that have always marked the Apreamare shipyard.

One of project's innovations is represented by the positioning of the L-shaped galley in the middle of the boat.

For the external spaces it has been privileged the solutions that represent the main and successful points of the range, as the harmonious style for the comfortable dinette and the spacious sundeck, placed at the bow and usable also during the navigation.

For the stern area we can find again the functional dinette with sinuous geometries that recall the hull lines. The appreciated essential and elegant forms are enriched by mahogany and steel finishing touches.

WINDWARD ISLANDS GIVES YOU THE OPPORTUNITY TO DEVELOP A CREWED CHARTER BUSINESS THROUGH A TAILORED MANAGEMENT PROGRAM.