



NAUTITECH 442
NAUTITECH 442 Owner version (2014)

Ref1146

Nautitech

Located: France

Plan intérieur Nautitech version 2 cabines

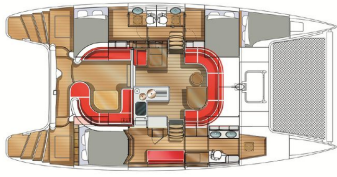

NAUTITECH 442
NAUTITECH 442 Owner
version (2014)

Nautitech

Length 13.5 M (45')

Located: France

Ref1146

€ 441 300
FOR CHARTER



Type	Modern
Propulsion	Sail
Hull	Catamaran
Length	13.5m (45')
Beam	6.8m (23')
Draft	1.2m (4')
Hull Material	Fiberglass
Engine	2 / Yanmar / 3JH4-CE
Engine HP	39
Guests	6
Guest Cabin(s)	3
Built/Refit	2014/-
Builder	Nautitech shipyard / Mortain & Mavrikios

Comments: With its 2 steering wheels, **Nautitech 442 is still the boat for long trip.**

The new version of the Nautitech 441 & 442 now has new hull portholes and semi flush deck hatches... A new look for the 44 footers :

- Larger hull portholes for better light
- Semi flush deck hatches
- Improved French doors access to main saloon
- Major weight saving through the use of foam cored furniture and hull stringers, coupled with resin infusion/foam sandwich laminate in the hull.

Swift and easy to manoeuvre with a limited crew, its autonomy is increased by the water recovery system integrated into the roof: As required, the saline test after the first rainfall can be carried out either manually or automatically via a dedicated reservoir with a 400 litre capacity.

This innovation as well as the possibility of fixing solar panels to the roof is a real answer to autonomy when sailing long distances.

This model, continually undergoing developments since it came on the market, has plenty of surprises in store !